

1LES121RD

DESCRIZIONE Lavello Easy incasso da 116x50 - 1 vasca + gocciolatoio
DESCRIPTION 116x50 built-in Easy sink - 1 bowl + drainer

PESO LORDO 12 KG
GROSS WEIGHT

DIMENSIONI IMBALLO 1210x530x220
PACKAGING DIMENSIONS

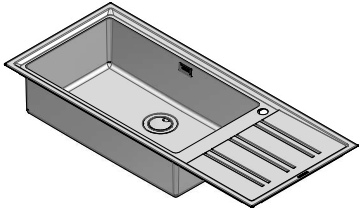

- Acciaio Inox AISI 304 di spessore elevato (*extra thick AISI 304 stainless steel*)
- Vasca raggio "15" (*bowl with radius "15"*)
- Dimensione vasca: 71x40x21.5 h (*bowl dimension: 71x40x21.5 h*)
- Dotazioni: pilettone 3" 1/2, copripilettone in acciaio inox, troppo pieno con scarico perimetrale (*equipment: 3" 1/2 stainless steel basket strainer waste, stainless steel drain cover, perimeter overflow*)
- Foro rubinetto: 1 foro di serie, 2° foro su richiesta (*tap hole: 1 standard hole, 2nd hole upon request*)
- Base inserimento vasca: 90 (*90cm base unit for bowl*)
- Incasso: 114x48 cm (*built-in: 114x48 cm*)

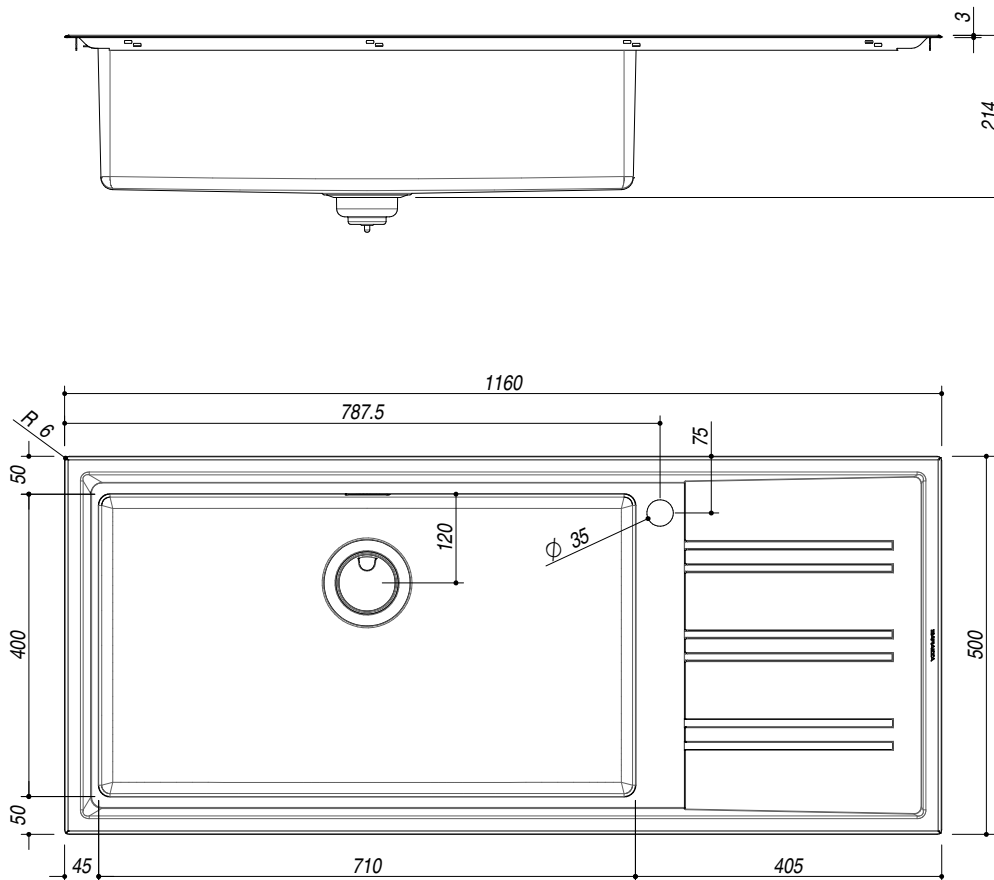

SCALA DISEGNO 1:10
DRAWING SCALE



TUTTE LE MISURE IN mm
ALL MEASURES IN mm

TOLLERANZA LINEARE: ± 0.5 mm
LINEAR TOLLERANCE

TOLLERANZA ANGOLARE: ± 0.2 °
ANGULAR TOLLERANCE

FORATURA PER INSTALLAZIONE AD INCASSO
BUILT-IN CUTOUT FOR TOP

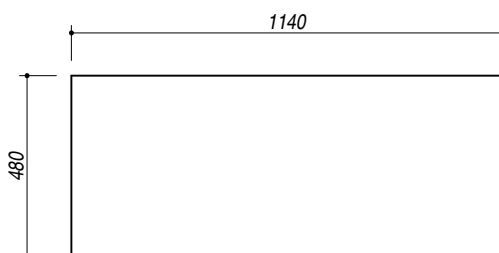

1:20